

## 92-B-59 - SPEEDLINE System Data Sheet - Version V1 (24-10-23)

SPEEDLINE 92mm 'C' Stud Partition @600mm Ctrs,  
with 2x BG Gyproc 12.5mm SoundBloc each side

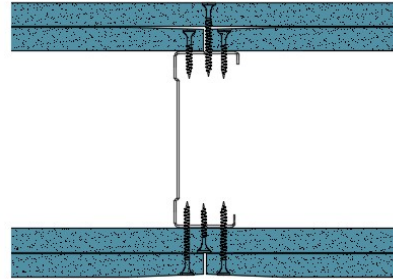

### System Performance Breakdown

Fire Resistance:

BS476 Part 22:1987:

Test Ref & Date or Applied Ref & Report:

Max Height:

Thickness:

Duty Grade: BS 5234: Part 2:1992:

Sound Insulation:

**60/60 Minutes** (Integrity/Insulation).

**BTC 17580F - BRE Report P102396-1011A**

**Refer to Speedline Specification Clause**

**142 mm.** (At Base Track, Excluding Finishes)

**Severe - Annexes A-F**

**53  $R_w$ dB**, Date Tested or Assessed Against - 70-B-59

Test Code:  
**H17456AA**  
Test Date:  
29/06/2011

| Freq. Hz | R dB |
|----------|------|
| 50       | 23.7 |
| 63       | 12.7 |
| 80       | 14.7 |
| 100      | 27.7 |
| 125      | 31.8 |
| 160      | 35.8 |
| 200      | 41.3 |
| 250      | 42.6 |
| 315      | 45.0 |
| 400      | 48.9 |
| 500      | 53.1 |
| 630      | 54.0 |
| 800      | 58.3 |
| 1 000    | 60.6 |
| 1 250    | 63.8 |
| 1 600    | 67.6 |
| 2 000    | 68.3 |
| 2 500    | 60.7 |
| 3 150    | 53.4 |
| 4 000    | 55.5 |
| 5 000    | 59.2 |
| 6 300    |      |
| 8 000    |      |
| 10 000   |      |

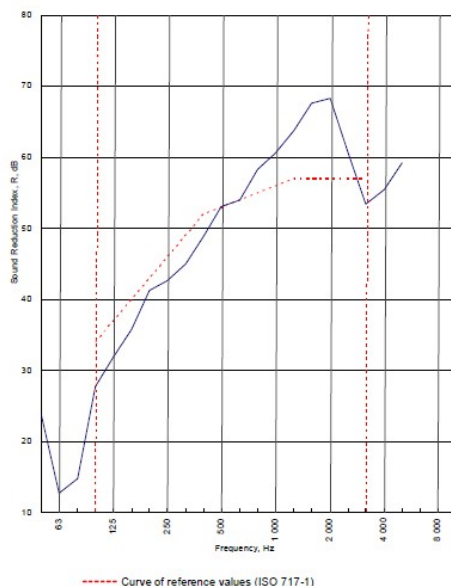



|   |   |                          |                          |
|---|---|--------------------------|--------------------------|
| Rating according to BS EN ISO 717-1:1997  | <b><math>R_w</math> (C;Ctr) = 53 (-2;-8) dB</b> |                          |                          |
| Evaluation based on laboratory measurement results obtained by an engineering method: | Max dev. 6.3 dB at 100 Hz                       |                          |                          |
|   | $C_{50-3150}$ = -9 dB                           | $C_{50-5000}$ = -8 dB    | $C_{100-5000}$ = -2 dB   |
|   | $C_{1,50-3150}$ = -21 dB                        | $C_{1,50-5000}$ = -21 dB | $C_{1,100-5000}$ = -8 dB |

TESTED AT ONE OF THE UKAS ACCREDITED LABORATORIES BELOW

B.T.C (H-Ref on Graph) 

B.R.E 

AIRO 

S.R.L 

Customer: **Metsec plc Hepsec Division**

BTC 17456A: Page 8 of 10

